

CURRENT 80 Ampere
VOLTAGE RANG 600 Volts

DATA SHEET

TYPE: 80A/600V

Package: T0-3P

Prepared by	Audit by	Approved by

APT80DQ60BG

CURRENT 80 Ampere
VOLTAGE RANG 600 Volts

Product specifications

VRRM = 600V
IFAV = 80A(40A*2)
VF = 1.3V
TRR = 60ns

Product Application:

- Switch mode Power Supply
- Welder
- Free Wheeling Diode
- Motor Controllers
- Converters
- Inverters
- Snubber Diode
- PFC

Product Features:

- Ultrafast Recovery Times
- Soft Recovery Characteristics
- Popular TO-3P Package
- Low Forward Voltage
- Low Leakage Current
- Avalanche Energy Rated

Product Benefits:

- Low Losses
- Low Noise Switching
- Cooler Operation
- Higher Reliability Systems
- Increased System Power Density

Package:

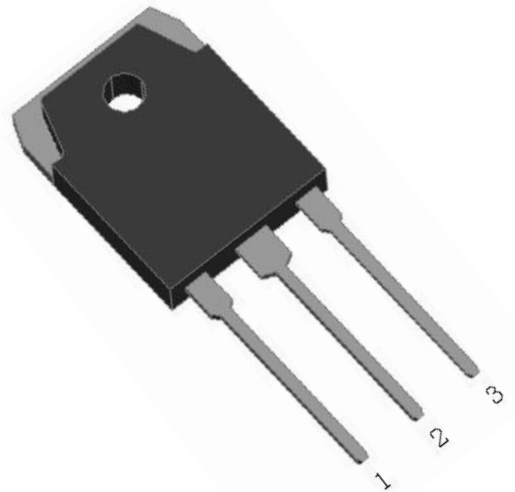

Circuit diagram

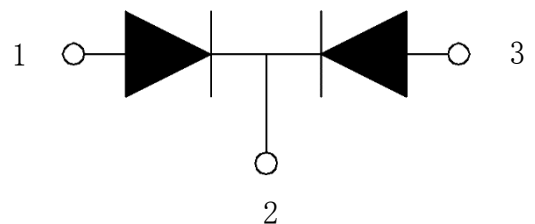

1- Anode
3- Anode
2- Cathode
Back of Case - Cathode

CURRENT 80 Ampere
VOLTAGE RANG 600 Volts

APT80DQ60BG

MAXIMUM RATINGS

All Ratings: Tc = 25° C unless otherwise specified.

Symbol	Characteristic / Test Conditions	TYP	UNIT
VR	Maximum D.C. Reverse Voltage	600	Volts
VRRM	Maximum Peak Repetitive Reverse Voltage		
IF(AV)	Maximum Average Forward Current (Tc = 100°C, Duty Cycle = 0.5)	80(40*2)	Amps
IFSM	Non-Repetitive Forward Surge Current (TJ = 25°C, 10ms)	600	
TJ , TSTG	Operating and Storage Temperature Range	-55 to 150	° C
TL	Lead Temperature for 10 Sec	260	

STATIC ELECTRICAL CHARACTERISTICS

Symbol	Characteristic / Test Conditions	TYP	MAX	UNIT	
VF	Forward Voltage	IF = 40A, TJ = 25°C	1.3	1.7	Volts
		IF = 40A, TJ = 150°C	1.0	1.3	
IRM	Maximum Reverse Leakage Current	VR = 600V, TJ =25°C		10	μ A
		VR = 600V, TJ =150°C		500	
Trr	Reverse Recovery Time	IF=0.5A IRM=1A IRR=0.25A TC=25°C	60	80	ns
CJ	Junction Capacitance, VR =200V	25		pF	

THERMAL AND MECHANICAL CHARACTERISTICS

Symbol	Characteristic / Test Conditions	APT80D60BG	UNIT
Rθ JC	Junction-to-Case Thermal Resistance	0.8	°C/W
WT	Package Weight	6.7	g
Torque	Maximum Mounting Torque	1.1	N.m

CURRENT 80 Ampere

VOLTAGE RANG 600 Volts

TYPICAL PERFORMANCE CURVES

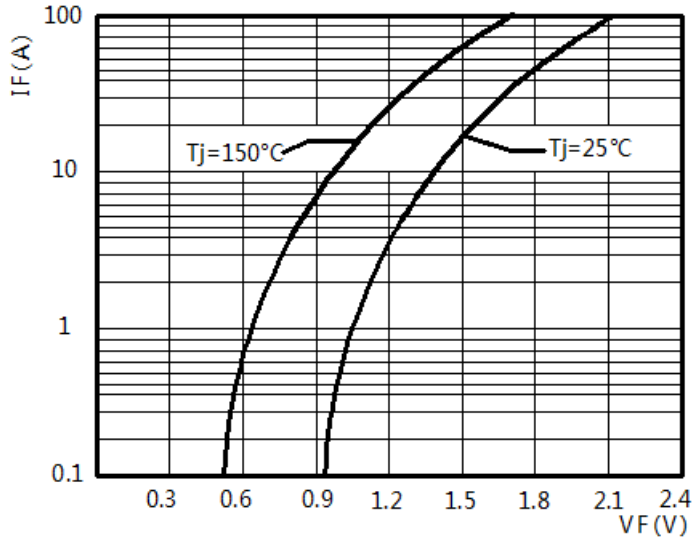

FIGURE 1. FORWARD CURRENT vs FORWARD VOLTAGE

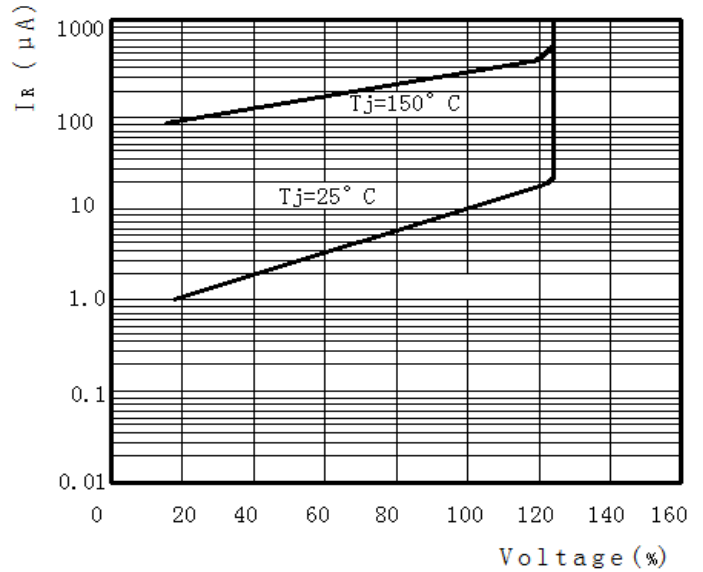

FIGURE 2. REVERSE CURRENT vs REVERSE VOLTAGE

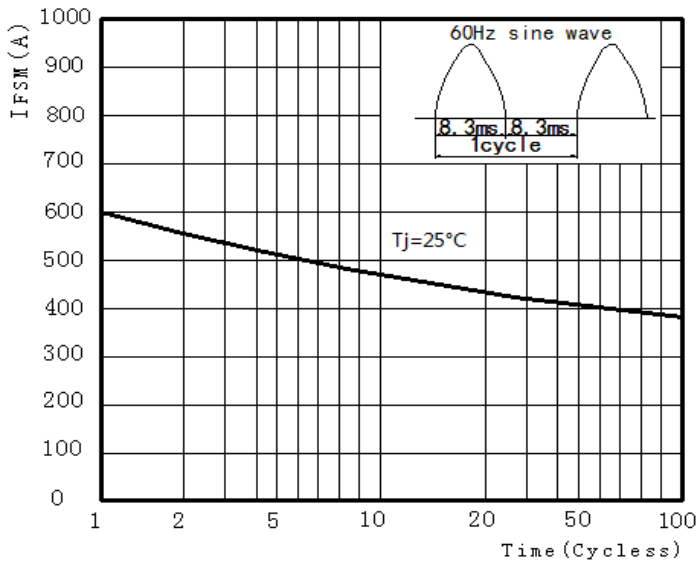

FIGURE 3. Peak Surge Forward Capability

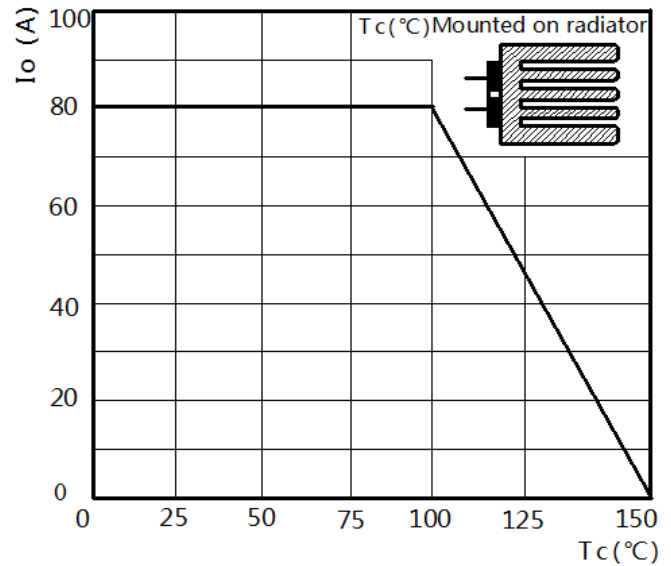

FIGURE 4. CURRENT DERATING CURVE

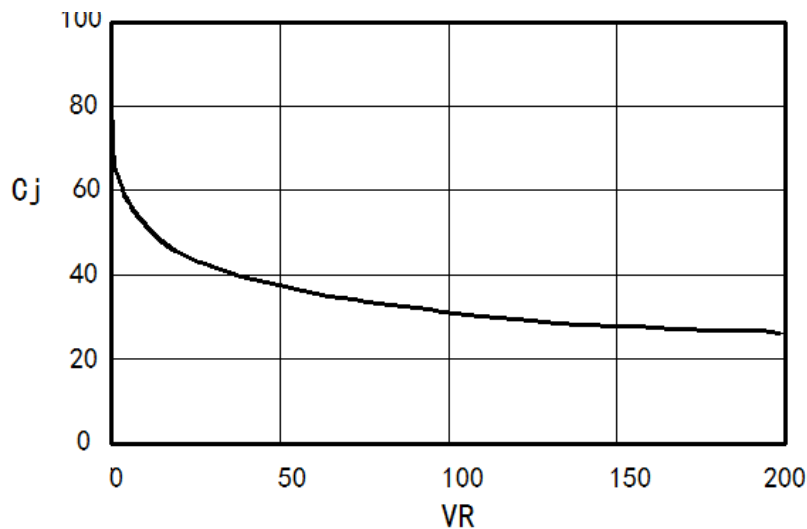
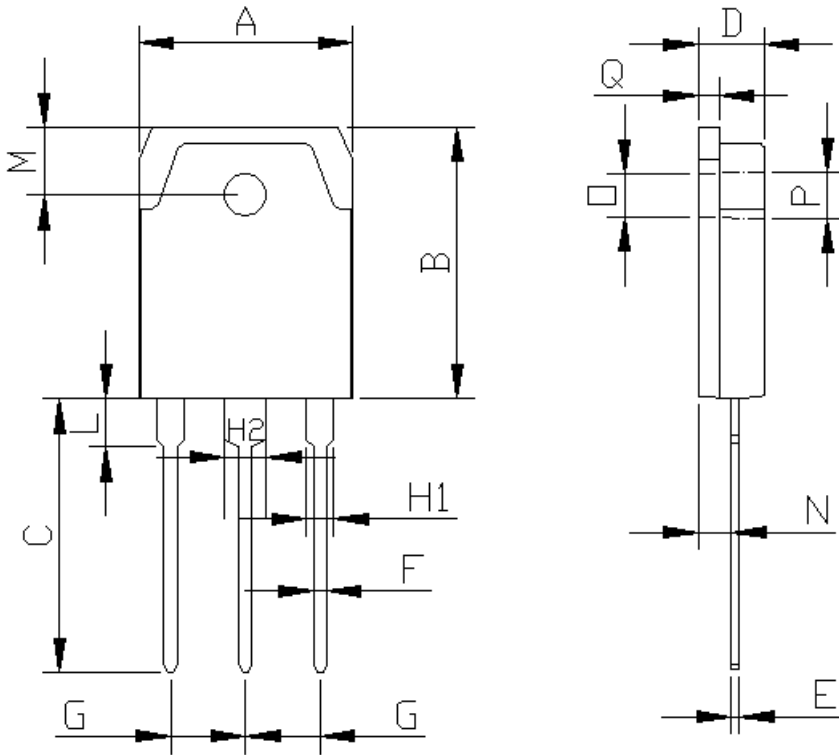

FIGURE 5. JUNCTION CAPACITANCE vs REVERSE VOLTAGE

CURRENT 80 Ampere

VOLTAGE RANG 600 Volts

Dimensioned drawing (T0-3P)



Dim.	Millimeter		Inches	
	min	max	min	max
A	15.1	16.1	0.594	0.634
B	19.4	20.4	0.764	0.803
C	19	20	0.748	0.787
D	4.3	5.3	0.169	0.209
E	0.4	0.8	0.016	0.031
F	0.8	1.2	0.031	0.047
G	5.25	5.65	0.207	0.222
H1	1.8	2.2	0.071	0.087
H2	2.8	3.2	0.110	0.126
L	2.7	3.1	0.106	0.122
M	4.7	5.3	0.185	0.209
N	2.2	2.6	0.087	0.102
O	3	3.3	0.118	0.130
P	3.3	3.6	0.130	0.142

Marking

